

Caring for your new bath and shower

Thank you for choosing Bain Magique^{MD}.

Please read the following information carefully. With just a little care and proper maintenance, you'll enjoy your new Bain Magique System for years to come.

There's a reason why millions of happy customers have trusted Bain Magique with their bath remodels. *Custom-made — and made for youTM.*

Caring for Your New Bath & Shower

CLEANING

Harsh scrubbing or prolonged soaking will not be necessary. Avoid harsh chemicals, disinfectants, and chemical drain cleaners. The use of unapproved cleaners on Bain Magique® acrylic tubs, walls, showers, and other acrylic products may cause serious damage and void your warranty. It is important that you **ONLY** use approved cleaners. Always rinse any cleaning product off tub and wall surfaces immediately. Cleaners should not be allowed to remain on the acrylic surfaces for any length of time. It is recommended to rinse soap residue from your bath, wall, shower, or other Bain Magique® acrylic products after each use. Regular cleaning will help keep your new unit looking great for years to come.

*The list of approved cleaners can be found on [mybathfitter.com/Products/Product Care and Cleaner's List](http://mybathfitter.com/Products/Product%20Care%20and%20Cleaner's%20List).

SILICONE CARE:

Allow the silicone on your new Bain Magique® products to set and cure properly. Wait 24 hours before manipulating any silicone joints and refrain from cleaning them for the first five days. Thereafter, we recommend that you remove excess water from all surfaces with a towel or squeegee after each use.

TIPS

- An environmentally friendly solution of water and white vinegar will also do a great job eliminating mildew on silicone and is cost effective.
- Cleaning the silicone regularly with a 50/50 mix of water and regular chlorine bleach will help kill any germs and/or bacteria lying on the surface.

TOBACCO:

Tobacco smoke in close proximity to your Bain Magique® bathtub and wall system may discolor the product and is **NOT** recommended.

SLIP-RESISTANT:

If your new Bain Magique® tub or shower base has been treated with a slip-resistant coating, we recommend it be recoated periodically to maintain its effectiveness.

IMPORTANT:

CAUTION - WET, SOAPY SURFACES CAN BE SLIPPERY. PLEASE BE EXTREMELY CAREFUL WHEN BATHING OR TAKING A SHOWER.

Plumbing & Valve Information

MOEN® MCORE® VALVE

Your Moen® MCORE® valve maintains constant balance between hot and cold water for total comfort. This valve includes adjustable water volume to suit your personal preferences, a *Temperature Limit Stop as a safety feature, and a Temperature Memory Feature.

The MCORE® valve operates by pulling the knob out to control water flow. Once the knob is pulled out to turn the water on, it is then rotated to select a temperature setting. Turn the valve handle counterclockwise for hot, clockwise for cold, or set it in the middle for a mix of both. To turn the water off, simply push the knob straight in. The next time you pull the knob out to use the faucet, the temperature setting will be the same as it was when you last used it.

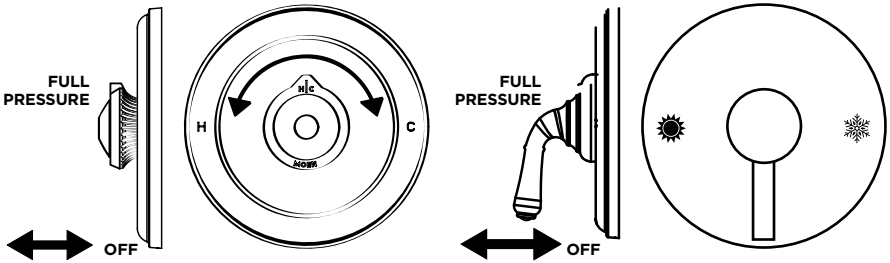

MOEN® POSITEMP® VALVE

Your Moen® Positemp® valve maintains a constant balance between hot and cold water for total comfort. For added safety, this valve includes a *Temperature Limit Stop.

The Positemp® valve operates by turning the handle counterclockwise to start the water flow. To change the water temperature to a higher (hotter) temperature, keep turning the handle counterclockwise until you reach your desired temperature. To turn the faucet off, turn the handle clockwise all the way back, until water flow stops.

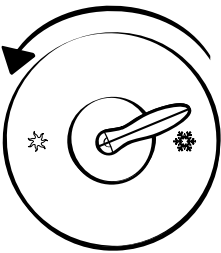

**Temperature Limit Stop allows you to control the degree of the water's heat.*

DIVERTER OPERATION WITH HANDHELD INSTALLED

Moen

For the Moen® diverter, turn the diverter valve “counterclockwise” to turn on the handheld function – turn it back for regular shower head use.

Delta

For the Delta® diverter, pull the diverter knob out to turn on the handheld function – push it in for regular showerhead use.

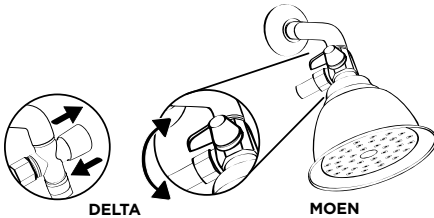

MOEN 3 FUNCTION TRIM KIT M-CORE

For the Moen® 3-function valve, the diverter can change the direction of water flow from:

1. The shower head,
2. The handheld shower head,
3. or a combination of both.

The valve turns the water on and changes the water temperature.

Please refer to Moen Posi-temp & M-Core Series 3 valves for more details.

NOTE:

If for any reason your water temperature is not satisfactory, DO NOT attempt to change the settings yourself. Please call Bain Magique® to have a technician stop by to adjust it.

Water pressure: If you have changed the valve/tap system to a newer model (regardless if it is from Bain Magique® or not), you may notice that the water pressure feels different. This is because all valves now have a “water-saver” feature built into them.

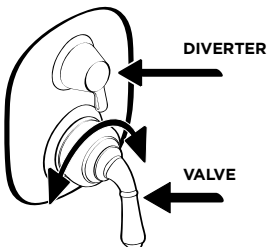

Drain

TO CLEAN THE DRAIN

If you notice that water takes longer than usual to drain from the tub, we recommend that you check for any hair or debris caught in the pop-up stopper. To remove the pop-up stopper, simply follow these easy instructions.

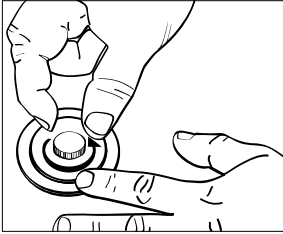

FIGURE 1

Hold the stopper and turn the cap counterclockwise.

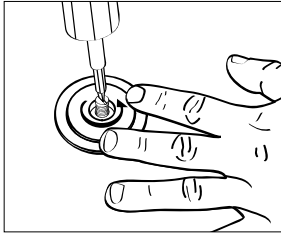

FIGURE 2

Use a slotted screwdriver to turn the brass screw counterclockwise.

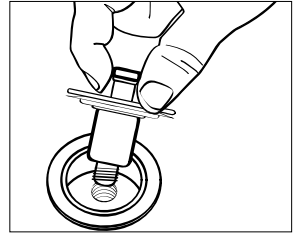

FIGURE 3

Pull out the stopper, remove any hair or debris from the drain, then re-install the stopper.

UN-CLOGGING DRAIN

PLEASE NOTE:

The use of any chemical drain “plungers” such as Drano, Liquid Plumber etc... could result in irreparable damage to the acrylic surface and will void the warranty.

To clear a clogged drain, remove the pop-up stopper. If the stopper is not clogged with hair, fill the bottom of the bathtub with approximately 1 inch of water and use a plunger. If there is not enough suction to clear away the clog (because air is passing through the overflow), remove the overflow cover and stuff a plastic bag into the overflow opening to block the flow of air. Continue to use the plunger. When done be sure to remove the plastic bag and reinstall the overflow cover.

If the above steps do not unclog your drain, Bain Magique® recommends another low-cost, natural solution. Remove the stopper and pour equal parts baking soda and white vinegar into the drain. Next, pour hot water into the drain. Re-install the pop-up stopper.

If these methods fail, it may be necessary to call in a plumber. Be sure to inform the plumber that use of unapproved chemical cleaners could cause irreparable damage to your Bain Magique® products and void the warranty.

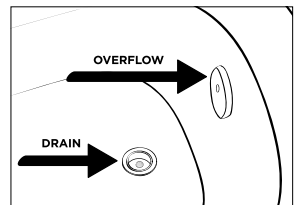

Drain Grab Bar

GRAB BAR BEAUTY RINGS

Bain Magique® grab bars have beauty rings covering the wall anchors. These rings are for aesthetic purposes and not meant to be tightly fixed to the wall anchors. A certain amount of movement in these beauty rings is normal.

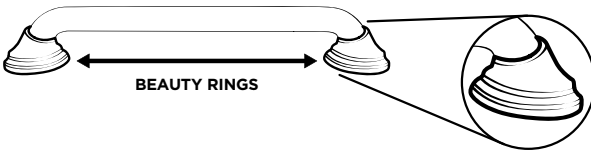

Tub & Shower Door Information

PROPER CLOSE POSITION

The design of the Bain Magique® tub and shower doors requires that the inner door be closed, as shown, to prevent water from the showerhead spraying between the glass panels and onto your bathroom floor.

CORRECT

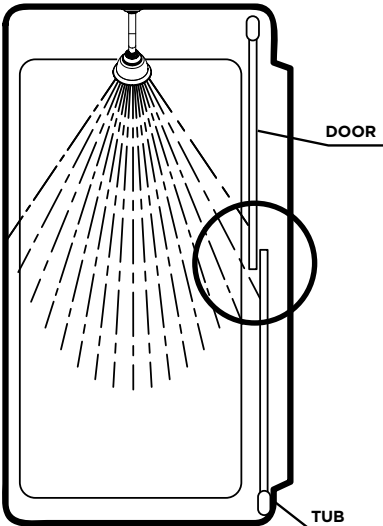

(OVERHEAD VIEW)

INCORRECT

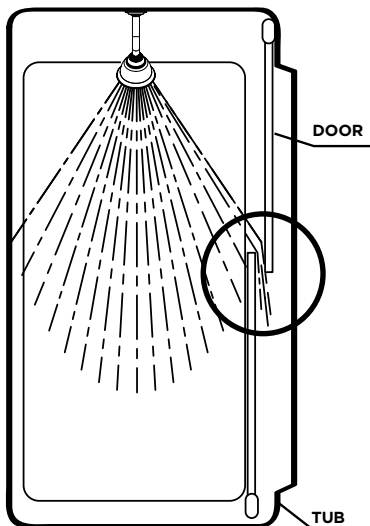

(OVERHEAD VIEW)



Letzte Garantie bei Bain Magique®-Produkten in Kanada.
Seit Kanada wird in den USA hergestellt.

FOR ALL INFORMATION CONCERNING THE BAIN MAGIQUE WARRANTY PLEASE VISIT OUR WEBSITE AT WWW.BAINMAGIQUE.COM/QC-EN/LIFETIME-WARRANTY/. FOR ANY ADDITIONAL QUESTIONS AND INFORMATION CONTACT OUR TOLL FREE NUMBER AT **1-877-632-6221**.

BAIN

MAGIQUE^{MD}

BAINMAGIQUE.COM

FOR ELECTRONIC VERSION OF THIS DOCUMENT
VISIT OUR WEBSITE BAINMAGIQUE.COM